



---

**INSTRUCTIONS FOR USE**  
REFRIGERATOR WITH FREEZER  
EN

RFB31231E1

# Contents

<b>Introduction</b> .....	<b>3</b>	Door compartments .....	13
Welcome to our growing ASKO family! .....	3	MultiBox * .....	13
<b>Important notes and precautions</b> .....	<b>4</b>	<b>Operating the appliance</b> .....	<b>14</b>
Before using the appliance for the first time .....	4	Switching the appliance on/off .....	14
Important safety instructions .....	4	Adjusting the temperature in the appliance .....	14
Important information on the use of appliance .....	6	Intensive cooling/freezing (SuperCool/FastFreeze) .....	15
<b>Installation and connection</b> .....	<b>8</b>	Open door alarm .....	16
Selecting the location .....	8	High temperature alarm .....	16
Connecting the appliance .....	9	<b>Storing food</b> .....	<b>18</b>
Changing the side on which the door opens / building the appliance into a cupboard .....	9	Recommended distribution .....	18
<b>Before using the appliance for the first time</b> .....	<b>10</b>	Avoid contamination of food .....	18
Before you use the appliance for the first time .....	10	Storing fresh food in the refrigerator .....	19
Energy-saving advice .....	10	Freezing and storing foods in the freezer .....	19
<b>Description of the appliance</b> .....	<b>11</b>	Thawing frozen food .....	21
Glass shelves .....	12	<b>Maintenance</b> .....	<b>22</b>
Bottle rack * .....	12	Defrosting the appliance .....	22
Fruit and vegetable drawer with automatic humidity control .....	12	Cleaning the appliance .....	22
		<b>Faults</b> .....	<b>24</b>
		Faults table .....	24
		<b>Environmental aspects</b> .....	<b>26</b>
		Disposal of packaging and appliance .....	26

## Welcome to our growing ASKO family!

We are proud of our appliances. We hope that this appliance will be an appreciated and dependable aid for many years to come.

Please read the operating instructions before use. They include general tips, information about the settings and adjustments you can make, and the best way to take care of your appliance.

### WARNING!

**Read the safety instructions before using the appliance!**

**Read these instructions thoroughly before you first use the appliance, and keep the instructions for future use.**

A section of the installation instructions is supplied separately.

### **Link to the EU EPREL database**

Information about your product can be found at [www.asko.com/energylabel](http://www.asko.com/energylabel), where you will also find a link to the European Product Database for Energy Labelling, EPREL. Or else visit <https://eprel.ec.europa.eu> directly. Follow the instructions to search by model name (see the information on the serial number plate).

The following symbols are used throughout the manual and they have the following meanings:

### INFORMATION!

Information, advice, tip, or recommendation

### WARNING!

Warning – general danger

### DANGER OF FIRE!

Warning; risk of fire / flammable materials

# Important notes and precautions

## Before using the appliance for the first time

Before connecting the appliance to the power mains, please read carefully the instructions for use which describe the appliance and its correct and safe use. The instructions apply to several appliance types/models; thus, settings or equipment may be described herein which is not available in your appliance. We recommend saving this instruction manual for future reference and attach it to the appliance if it is sold in the future.

Check for any damage or irregularities on your appliance. If you find your appliance is damaged, notify the retailer from which you have purchased the appliance.

Before connecting the appliance to the power mains, let the appliance rest in a vertical position for a minimum of 2 hours. This will reduce the possibility of operation faults due to the effect of transport on the cooling system.

## Important safety instructions



**WARNING!** Risk of fire/flammable materials.

The appliance must be connected to the power mains and grounded in compliance with the effective standards and regulations.

**WARNING!** Do not locate multiple portable socket-outlets or portable power supplies at the rear of the appliance.

Before cleaning the appliance, unplug it from the power mains (unplug the power cord from the wall outlet).



**ELECTRIC SHOCK!**

**WARNING!** If the supply cord is damaged, it must be replaced by the manufacturer, its service agent or similarly qualified persons in order to avoid a hazard.



**ELECTRIC SHOCK!**

**WARNING!** When positioning the appliance, ensure the supply cord is not trapped or damaged.



**ELECTRIC SHOCK!**

If LED lighting does not work, call a service technician. Do not attempt a repair of the LED lighting yourself, as there is danger of contact with high voltage!

## Important notes and precautions

### WARNING!

WARNING! Do not use electrical appliances inside the food storage compartments of the appliance, unless they are of the type recommended by the manufacturer.

### WARNING!

WARNING! Do not use mechanical devices or other means to accelerate the defrosting process, other than those recommended by the manufacturer.

### WARNING!

WARNING! To avoid any hazard resulting from poor stability of the appliance, make sure it is installed as instructed.

#### **Freeze burn hazard**

To avoid freeze burn, never put frozen food in your mouth and do not touch frozen food.

#### **Safety of children and vulnerable persons**

The appliance is not intended for use by persons (including children) with reduced physical, sensory or mental capabilities, or lack of experience and knowledge, unless they have been given supervision or instruction concerning use of the appliance by a person responsible for their safety.

Children should be supervised to ensure that they do not play with the appliance.

Cleaning and user maintenance shall not be made by children without supervision.

Remove the packaging intended to protect the appliance or particular parts during transport and keep it outside the reach of children. It presents danger of injury or suffocation.

## Important notes and precautions

When removing a used appliance, disconnect the power cord, remove the door, and leave the shelves in the appliance. This will prevent children from locking themselves in the appliance.

### **For European markets only**

This appliance can be used by children aged from 8 years and above and persons with reduced physical, sensory or mental capabilities or lack of experience and knowledge if they have been given supervision or instruction concerning use of the appliance in a safe way and understand the hazards involved.

Children shall not play with the appliance.

Cleaning and user maintenance shall not be made by children without supervision.

Children aged from 3 to 8 years are allowed to load and unload refrigerating appliances.

### **Warning regarding the refrigerant**

The appliance contains a small amount of an environmentally friendly yet flammable gas R600a. Make sure that no parts of the cooling system are damaged. A gas leak is not hazardous to the environment, but it could cause eye injury or fire.

In case of a gas leak, ventilate the room thoroughly, disconnect the appliance from the power mains, and call a service technician.

Important information on the use of appliance

**WARNING!** This appliance is intended to be used in household and similar applications such as:

- staff kitchen areas in shops, offices and other working environments;
- farm houses and by clients in hotels, motels and other residential type environments;
- bed and breakfast type environments;

## Important notes and precautions

- catering and similar non-retail applications.

### WARNING!

**WARNING!** Keep ventilation openings, in the appliance enclosure or in the built-in structure, clear of obstruction.

The appliance may not be used outdoors and it may not be exposed to rain.

**Do not store explosive substances such as aerosol cans with a flammable propellant in this appliance.**

If the appliance will be out of use for an extended period of time, switch it off using the relevant button, and unplug it from the power mains. Empty the appliance, defrost it, clean it, and leave the door ajar.

In case of an error or power supply failure, do not open the freezer compartment unless the freezer has not operated for over 16 hours. After this period, use the frozen food or provide sufficient cooling (e.g. a replacement appliance).

### **Technical information on the appliance**

Rating plate can be found in the appliance interior. It indicates data on voltage, gross and net volume, type and amount of refrigerant, and information on the climate classes.

If the language on the rating plate is not the language of your choice or the language of your country, replace it with the one supplied.

### WARNING!

**WARNING!** Do not damage the refrigerant circuit.

# Installation and connection

## Selecting the location

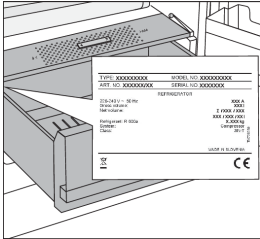

- Place the appliance in a dry and well aired room. The permitted ambient temperature range for the appliance depends on the appliance's climate class, which is shown on the type plate.

- Do not place the appliance near a source of heat, such as a gas cooker, radiator or boiler, etc., and do not expose it to direct sunlight.

Description	Class	Ambient temperature range °C	Relative humidity
Extended temperate	SN	+10 to +32	≤75%
Temperate	N	+16 to +32	
Subtropical	ST	+16 to +38	
Tropical	T	+16 to +43	

### WARNING!

Do not place the appliance in a room where the temperature can fall below 5 °C: the appliance may not work properly or become defective!

### WARNING!

The appliance is not suitable for outdoor use and it may not be exposed to rain.

- The appliance must be placed at a distance of at least 5 cm from an electrical or gas cooker and at least 30 cm from a radiator or heater. An insulation panel must be fitted when these distances cannot be kept.
- The appliance must be placed at a distance of about 5 cm from the wall, back and sides of a cupboard. A kitchen cupboard above the refrigerator must have a gap of at least 5 cm between the back of the cupboard and the wall. This is needed to make sure that there is sufficient cooling air for the condenser.
- The plug of the installed appliance must remain accessible!

### WARNING!

Place the appliance in a room with a sufficient volume of air. The room must have a volume of at least 1 m<sup>3</sup> of air for every 8 grams of refrigerant. The quantity of refrigerant is shown on the type plate on the inside of the appliance.



# Installation and connection

- The kitchen unit in which the appliance is to be built in must have an opening of at least 200 cm<sup>2</sup> in its base to allow sufficient air to circulate.
- The appliance's air outlet is at the top. Make sure that the outlet is not blocked. Blocking the outlet can result in damage to the appliance.

## WARNING!

### **Warning:**

An anti-condensation accessory must be installed before built-in appliances are installed next to each other in a cupboard or surround. **For safety reasons, this must be installed by a recognized installer!**

## Connecting the appliance

- Connect the appliance to the power supply with a plug. The socket must be earthed. The nominal voltage and frequency required for the appliance are shown on the appliance's type plate/label with basic information.
- The appliance must be connected to the mains and earthed in accordance with the prevailing standards and regulations. The appliance can withstand small variations in the mains voltage to a maximum of plus or minus 6%.

## WARNING!

When you are not going to use the appliance for a longer period then switch it off with the appropriate key and disconnect it from the mains. Empty, defrost and clean the appliance, and leave the door ajar.

## WARNING!

In the event of a defect or power cut, do not open the freezer compartment unless the appliance has been out of operation for more than the hours indicated on the appliance's type plate (temperature rise time). After this time, you must either use the frozen food or make sure that it is properly cooled (for example, by transferring it to another appliance).

## Changing the side on which the door opens / building the appliance into a cupboard

Information about changing the side on which the door opens and building the appliance into a cupboard is enclosed in separate installation instructions.

# Before using the appliance for the first time

## Before you use the appliance for the first time

Do not connect the appliance to the mains until you have carefully read the instructions for the correct and safe use of the appliance. As these instructions are for various types and models, it is possible that the instructions for use refer to settings or parts that are not available on your appliance. We recommend that you keep these instructions for future use. If you sell the appliance, enclose them with the appliance.

Inspect the appliance for damage and/or irregularities. If the appliance is damaged, contact the store that sold you the appliance.

Allow the appliance to stand upright for at least 4 hours before you connect the appliance to the mains. This reduces the risk of malfunctions resulting from transport effects on the refrigerant unit.

Before using the appliance for the first time, the interior and all internal accessories should be cleaned with lukewarm water and a neutral cleaning agent. Wipe the cleaned parts with a cloth with clean water and then dry them thoroughly.

If you use the appliance for the first time, do not put food into the appliance until the temperature has decreased to the set temperature.

## Energy-saving advice

- Install the appliance as stated in the instructions for use.
- Do not open the door more than necessary.
- Never cover or obstruct the ventilation openings.
- Replace a door seal that is damaged or no longer seals properly as quickly as possible.
- Store food in well-sealed containers or suitable packaging.
- Allow food to cool to room temperature before you put it in the appliance.
- Defrost food in the refrigerator compartment.
- Space the shelves evenly in the refrigerator compartment. Place the food so that the air can circulate freely in the appliance (follow the recommendations for the location of foods enclosed in the instructions).
- The lower the set temperature, the higher the power consumption.
- When the appliance is equipped with a fan then make sure that the ventilation openings are kept clear.

# Description of the appliance

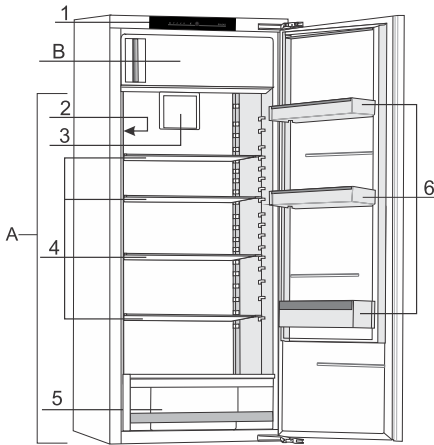

## **A Refrigerator**

## **B Freezer**

1. Control panel
2. LED lighting
3. CoolFlow
4. Glass shelves
5. Fruit and vegetable drawer with humidity control
6. Door compartments

## **CoolFlow**

This system creates optimal air circulation to keep the temperature constant throughout the entire refrigerator compartment. The openings around the fan may never be covered or obstructed.

# Description of the appliance

( \* Equipment depends on the model)

## Glass shelves

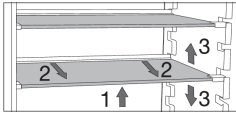

The shelves are made from safety glass. To change the height of a shelf, lift the front of the shelf (1). Take hold of the back and pull the shelf slightly forwards (2). Move the shelf to a higher or lower position (3).

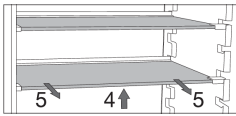

To remove a shelf from the refrigerator, lift the front of the shelf (4). Take hold of the back and pull the shelf out of the appliance (5).

## Bottle rack \*

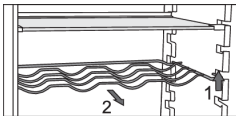

The bottle rack can contain a maximum load of nine 0.75-litre bottles or 13 kilograms of total weight. Also cans can be put on the bottle rack (lengthwise or crosswise). Make sure that the door can close correctly if you have put bottles or cans on the rack.

The bottle rack cannot accidentally be pulled out. It can only be pulled out when it is empty. To pull it out, lift it slightly at the front (1) and pull it towards you (2).

## Fruit and vegetable drawer with automatic humidity control

- The drawer at the bottom of the refrigerator is intended for storing fruit and vegetables. It provides humidity and prevents the food from drying out.
- The humidity in the drawer is regulated automatically, depending on the type and amount of inserted food.

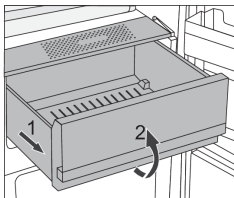

To remove a drawer, pull out the drawer as far as it will go (1). Then, lift the front part (2) and pull it out completely.

# Description of the appliance

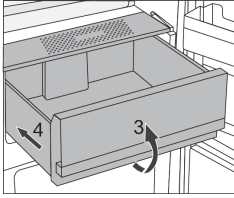

To insert a drawer, follow the reverse order (3 and 4).

## Door compartments

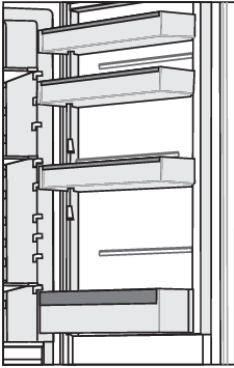

The height of the door compartments is adjustable. Lift the compartment out of the groove and fit it in the required position. Each compartment can carry a maximum weight of 5 kg. The bottom door compartment is suitable for bottles.

## MultiBox \*

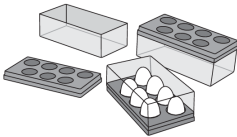

The MultiBox offers a handy option for storing foods with a strong odour, such as ripe or blue cheese, smoked sausages and onions.

If the tray is used as an egg tray, place it directly on the bottom of a door shelf.

If the tray is used as an ice tray, fill it with water and place it in the freezer in a horizontal position.

# Operating the appliance

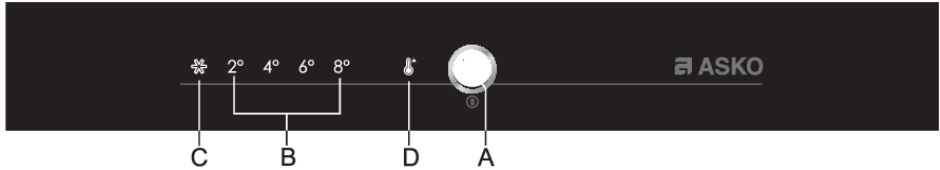

- A** Appliance on/off, temperature settings, and extra function key
- B** Refrigerator compartment temperature display  
The indicator for the selected temperature will be lit.
- C** Intensive cooling/freezing function indicator  
Symbol **C** will be lit when the intensive cooling/freezing function is activated.
- D** High temperature indicator

To set the appliance temperature or activate extra functions, press the **A** key successively. When the key is first pressed, the currently set value or function will start to flash. With each successive press of the key, the indicator moves to the next setting. The indicator cycles through the settings in a circular manner, from right to left. While the settings are being adjusted, the display will flash. Three seconds after the key is released, the setting will be stored automatically and the relevant symbol will be lit.

## Switching the appliance on/off



**Switching the appliance on:** Press the **A** key and hold it for 3 seconds.

**Switching off the appliance:** Again press the **A** key and hold it for 3 seconds. The appliance will be off, but there is still voltage in it as it is still connected to the power mains.

## Adjusting the temperature in the appliance

### ⚡ INFORMATION!

- The factory default setting is the recommended temperature of 4 °C. At this setting, the temperature in the freezer compartment will be around -18 °C.

### ⚠ WARNING!

After you have switched on the appliance it will take several hours for the temperature to decrease to the set temperature. Do not put food into the appliance until the temperature has decreased to the set temperature.

# Operating the appliance



- Adjust the temperature as desired using the **A** key.
- Press the **A** key (several times) until the desired temperature indicator lights up.
- When the **A** key is pressed for the first time, the currently set value or function will start to flash. Every successive time you press the **A** key, the settings indicator will move to the next setting (from right to left, in a circular manner).
- After three seconds, the setting will stop flashing. Your setting will be stored and the corresponding indicator will be continuously lit.

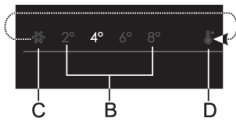

The numbers 2, 4, 6 and 8 indicate the degrees Celsius (°C) in the refrigerator compartment.

- The recommended temperature setting is +4 °C. At this temperature, food quality and freshness are preserved longer.
- The temperature in the refrigerator compartment also affects the temperature in the freezer compartment. For a lower temperature in the freezer compartment, set a lower temperature in the refrigerator compartment.
- If the ambient temperature in the room where the appliance is installed is below 16 °C, we recommend setting a temperature lower than 4 °C.

## Intensive cooling/freezing (SuperCool/FastFreeze)

This appliance has an intensive cooling/freezing function. This function decreases the temperatures in the refrigeration compartment and freezer compartment as quickly as possible. Activate this function 24 hours before you put a large quantity of fresh food in the appliance.

### WARNING!

When the intensive cooling/freezing function is selected, the appliance works at maximum capacity. It may then make more noise for a while.

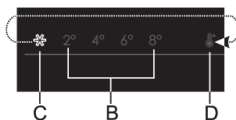

- To activate the intensive cooling/freezing function, press the **A** key several times until symbol **C** lights up.
- To switch off the intensive cooling/freezing function, press the **A** key to select the desired temperature **B**.

### INFORMATION!

Adjusting the temperature of the refrigeration compartment while the intensive cooling/freezing function is activated will immediately disable the intensive cooling/freezing function.

# Operating the appliance

## INFORMATION!

When the intensive cooling/freezing function is not manually disabled then the function will be automatically disabled after about two days. The temperature then returns to the latest temperature setting.

## INFORMATION!

Should a power failure occur while the function is activated then the function will be activated again when the power is restored.

## Open door alarm

An alarm signal sounds when a door is open for too long.

### Switching off the alarm:

1. Close the door.
  - The alarm will stop sounding.

## INFORMATION!

If you only switch off the alarm by touching the **A** key, the alarm will switch on again after some time because the door is still open.

## High temperature alarm

A signal will sound when the temperature in the appliance is too high. Furthermore, symbol **D** shown in the display will flash. A high temperature can be caused for several reasons:

- The door has been opened for too long or too frequently.
- The door does not seal properly.
- Too much fresh food has been put in at the same time.

## WARNING!

Every time the appliance is switched on again, it takes a while until the correct temperature is reached. For this reason, the alarm is disabled for the first 24 hours after the appliance is switched on to prevent the unnecessary activation of the alarm.

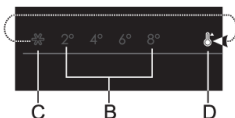

### Switching off the alarm:

1. Touch the **A** key to stop the alarm.
  - The alarm will stop sounding.
  - Symbol **D** shown in the display continues to flash while the temperature is still too high.



## INFORMATION!

When you press the **A** key for the first time, the alarm will be acknowledged and turned off. When you press the **A** key again, it will already work as a settings adjustment key.

## WARNING!

When the alarm is not stopped manually and the temperature remains too high, the signal will sound for the first minutes of every half hour and when the door of the refrigerator compartment is opened.

# Storing food

## Recommended distribution

### Sections of the refrigeration compartment

- Upper section: canned food, bread, wine and pastas, etc.
- Middle section: dairy products, ready-to-cook meals, desserts, soft drinks, beer and cooked food, etc.
- Lower section: meat, meat produce, delicatessen.
- Vegetable drawer: vegetables and fresh fruit.

### INFORMATION!

Store food that spoils rapidly at the back of a shelf or at the back of the drawer at the lowest temperature.

### WARNING!

Do not store fruit (bananas, pineapples, papaya, citrus fruits) and vegetables (courgettes, tomatoes, aubergines, cucumber, sweet peppers and potatoes) that are sensitive to low temperatures in the refrigerator.

### Sections of the door

- Top/middle door compartments: eggs, butter, cheese and sauces, etc.
- Bottom door compartments: drinks, cans and bottles, etc.

### Freezer compartment

- For freezing fresh food and to store frozen foods.

### WARNING!

Do not store lettuce, eggs, apples, pears, grapes, peaches, yoghurt, buttermilk, sour cream or mayonnaise in the freezer.

## Avoid contamination of food

To avoid contamination of food, please respect the following instructions:

- Opening the door for long periods can cause a significant increase of the temperature in the compartments of the appliance.
- Regularly clean surfaces that can come in contact with food and accessible drainage systems.
- Store raw meat and fish in suitable containers in the refrigerator, so that it is not in contact with or drip onto other food.
- If the refrigerating appliance is left empty for long periods, switch off, defrost, clean, dry, and leave the door open to prevent mould developing within the appliance.

## Storing fresh food in the refrigerator

### **Important recommendations for storing fresh food**

- To ensure the quality of fresh food, it is important that:
  - the food is well-packaged;
  - the appliance is at the correct temperature;
  - the appliance is clean.
- Take good note of the use-by date stated on the food packaging.
- Put food in the refrigerator in sealed containers or in suitable packaging. This will prevent the food from picking up or spreading odours and will keep it dry.
- Do not store flammable, unstable or explosive materials in the refrigerator.
- Store bottles that have been opened upright and close them tightly.
- Some organic solutions, such as essential oils, in the skin of lemons and oranges, and butyric acid, that come into long-term contact with plastics can eat into the material and cause premature ageing.
- A disagreeable odour is an indication that the appliance is not clean or that it contains food that has spoiled (see the chapter 'Maintenance').
- Take perishable foods out of the refrigerator when you will be away from home for a longer time.

## Freezing and storing foods in the freezer

### **Important recommendations for freezing fresh food**

- The maximum quantity of food that you can put in the freezer in one go is stated on the type plate. Putting more than this maximum quantity of food into the freezer will slow the freezing process and reduce the quality. Moreover, this will also harm the quality of frozen food already stored in the freezer.
- Use only good-quality fresh food that is suitable for freezing.
- Allow hot food to cool to room temperature.
- Food needs to be frozen quickly. It is recommended that you use small packs.
- Use air and watertight packaging to prevent the food from drying out and lose its vitamins.
- Note the type and quantity of the food on the packaging, together with the date on which it was frozen.
- Do not allow fresh food to come into contact with frozen food.
- You can remove all the drawers to make use of the total volume of the freezer compartment.
- Put the food directly on a shelf and on the base of the freezer.

### **Freezing small quantities of fresh food/making ice cubes**

See the chapter 'Recommended distribution' for the best location for freezing fresh food (1 to 2 kilograms) and making ice cubes.

### **Freezing large quantities of fresh food**

- Activate the intensive freezing function 24 hours before you plan to freeze the food.
- Distribute the fresh food equally between all the drawers in the freezer compartment.
- After 24 hours, you can transfer the food to another compartment in the freezer and then freeze a new batch of food.

# Storing food

## Important recommendations for storing frozen food

- Follow the manufacturer's instructions for the storage and use of frozen food. Take note of the recommended storage temperature and use-by date stated on the packaging.
- Use only food in undamaged packaging that has been stored at a temperature of -18 °C or lower.
- Do not buy food covered in frost. This indicates that the food has thawed or partially thawed several times and, as a result, is of inferior quality.
- Make sure that the food does not thaw during transport. An increase in its temperature will shorten the storage life and harm the quality of the food.

Recommended storage times of frozen food in the freezer 

Type of food	Storage life
Fruit, beef	10 to 12 months
Vegetables, veal, poultry	8 to 10 months
Venison	6 to 8 months
Pork	4 to 6 months
Finely chopped or minced meat	4 months
Bread, pastas, cooked dishes, whitefish	3 months
Offal	2 months
Smoked sausage, bluefish	1 month

## Thawing frozen food

- Thawing is an important step in storing food preserved by freezing. Food must be thawed in the correct way.
- Suitable methods of thawing food are:
  - in the refrigerator;
  - in cold water;
  - in a microwave or conventional oven with a suitable thaw program.
- Some frozen products can be prepared without needing to thaw them first. The manufacturer will state this on the packaging.
- The food needs to be packed in small portions. In this way the food thaws faster.
- Use partially or completely thawed food as quickly as possible. The bacteria in thawed food are reactivated and the food will spoil rapidly. This applies in particular to fruit, vegetables and ready-made food.
- Do not refreeze partially or completely thawed food.

# Maintenance

## Defrosting the appliance

### **Automatic defrost of the refrigeration compartment**

The refrigeration compartment defrosts automatically from time to time.

## Cleaning the appliance

### **WARNING!**

Switch off the appliance and remove the plug from the socket before you start cleaning it.

### **WARNING!**

Do not use abrasive cleaning agents, as they can damage the surface.

### **INFORMATION!**

Activate the intensive freezing function 24 hours before you plan to clean the freezer.

- Regularly clean the interior of the appliance with lukewarm water. If so required, add a neutral cleaning agent or special refrigerator cleaner to the water. Clean all surfaces with a soft cloth. Wipe the cleaned parts with a cloth with clean water and then dry them thoroughly.
- Do not put parts of the appliance in a dishwasher: this could damage them.
- Clean wooden parts with a damp cloth. Make sure that the wood does not become too wet and allow the parts to dry thoroughly before you put them back into the refrigerator.
- Warning: Wood is a natural material. This means that it will be difficult to remove some stains (especially red wine and oil).
- Wooden accessories that have dried out will need to be treated with a wood oil. This product must be suitable for treating surfaces that come into direct contact with food.

### **WARNING!**

When you are not going to use the appliance for a longer period then switch it off with the appropriate key and disconnect it from the mains. Empty, defrost and clean the appliance, and leave the door ajar.

## Cleaning the humidity filter

The humidity filter is located at the bottom part of the shelf above the fruit and vegetable drawer.

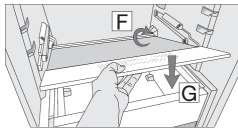
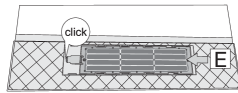
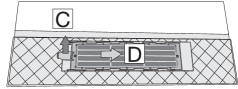
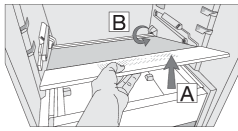

1. Remove the upper drawer.
2. Lift the shelf as far as possible at the front (A). Then, pull it out from the grooves at the rear side of the appliance (B).
3. Carefully turn the shelf around so the lower side is facing upwards.
4. Put the shelf onto a flat surface.
5. To remove the filter, lift up the tab as indicated by arrow C. Then, slide the filter in the direction indicated by arrow D.
6. Wash the filter with water and dry it thoroughly. If there are stubborn stains on the filter, clean them with mild detergent and a soft cloth. Then, rinse out the detergent thoroughly with water.
7. Put the filter back: slide it in the direction indicated by arrow E. A 'click' indicates that the filter is firmly back in place.
8. Turn the shelf around and put it back. Make sure it fits well into the grooves at the rear wall of the appliance (arrow F). Carefully lower the shelf to put it on top of the fruit and vegetable drawer as indicated by arrow G.

# Faults

## Faults table

When you have any doubts about whether your appliance is working properly you should not immediately assume that it is defective. We recommend that you should in any case check the points in the following table.

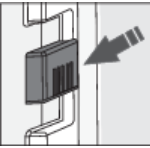
Problem	Cause/Solution
Appliance is connected to the power mains but it does not work.	<ul style="list-style-type: none"> <li>• Make sure there is voltage in the power outlet and that the appliance is switched on.</li> </ul>
<p>Appliance cools continuously for a long time.</p> 	<p>The compressor is operating for a longer time at low capacity (low energy consumption / high efficiency). This is the most efficient form of operation. The following factors can also influence the appliance's operation:</p> <ul style="list-style-type: none"> <li>• The ambient temperature is too high.</li> <li>• The door has been opened for too long or too frequently.</li> <li>• The door is not closed properly.</li> <li>• The door does not seal properly (the seal is dirty, the door is misaligned or the seal is damaged, etc.).</li> <li>• Too much fresh food has been put in at the same time.</li> <li>• Insufficient air circulation around the compressor and condenser. Check that the ventilation around the appliance is sufficient (see the separate installation instructions).</li> <li>• The sensor in the refrigerator is blocked by fresh food. Make sure that air can circulate freely around the sensor (not applicable to all models).</li> </ul>
Condensation on the glass shelf above the drawers in the refrigeration compartment.	<ul style="list-style-type: none"> <li>• Check that the door is closed properly and seals properly.</li> <li>• This is a temporary problem that cannot be avoided entirely in periods of high ambient temperatures and high humidity. The problem disappears when the temperature and humidity return to normal levels. We recommend that you clean the drawers more frequently and occasionally wipe off any drips.</li> <li>• Pack food in bags or other air-tight packaging.</li> </ul>
Symbol <b>D</b> flashes.	<ul style="list-style-type: none"> <li>• The door has been opened for too long or too frequently.</li> <li>• The door does not seal properly (the seal is dirty, the door is misaligned or the seal is damaged, etc.).</li> <li>• Too much fresh food has been put in at the same time.</li> </ul>
Door does not open easily.	<p>You are trying to open the appliance's door just after you have closed the door. Then opening the door is difficult. When you open the door, cold air escapes from the appliance and is replaced by warm air from the surroundings. As this air cools a slight vacuum is created that makes it more difficult to open the door. The situation returns to normal after a few minutes, and the door opens easily again.</p>
LED lighting does not work:	<ul style="list-style-type: none"> <li>• Consult a service technician about LED lighting that is not working. For safety reasons, you are not allowed to repair LED lighting yourself.</li> <li>• This product contains a light source of energy efficiency class E.</li> </ul>



Problem	Cause/Solution
Appliance makes a noise.	<ul style="list-style-type: none"> <li>• The appliance is cooled by a refrigeration system with a compressor (and with some models, also a fan) that makes a noise. The noise level depends on the installation of the appliance, its correct use and its age.</li> <li>• When you connect the appliance to the power supply the noise made by the compressor or flowing refrigerant may be slightly louder. This is not indicative of a defect, and has no effect on the service life of the appliance. The appliance will make less noise after a while.</li> <li>• The appliance may be temporarily noisier after the door has been opened for too long or too frequently, a large quantity of fresh food has been put in the appliance or the intensive freezing or intensive cooling function has been activated.</li> </ul>

If you are unable to solve the problem then contact the service centre. When you do so, state the type, model and serial number shown on the type plate or label on the inside of the appliance.

# Environmental aspects

## Disposal of packaging and appliance

This appliance is made from sustainable materials. This appliance must be disposed of in a responsible manner at the end of its service life. Contact the local authorities for information about the method.

### INFORMATION!

See also the chapter 'Disposal' in the Safety instructions.

The packaging of the appliance is recyclable. The following materials may have been used:

- Cardboard.
- Polyethylene foil (PE).
- CFC-free polystyrene (hard PS foam).

These materials must be disposed of in a responsible manner and in accordance with government regulations.



The appliance is marked with a crossed out wheeled bin symbol to draw your attention to the requirement for the separate disposal of domestic electrical appliances. This means that the appliance may not be disposed of in unsorted household waste at the end of its service life. The appliance must be taken to a special municipal waste processing location for separated waste or to a dealer who provides this service.

Collecting and disposing of domestic appliances separately avoids detrimental consequences for humans and the environment. This ensures that the materials used to make the appliance can be recovered and that substantial savings in the use of energy and raw materials can be achieved.



### **Declaration of conformity**

We hereby declare that our products conform to the applicable European Directives, Regulations and requirements, as well as all requirements in the standards to which reference is made.

---

---

---

---

---

---

---

---

---

---

---

---

---

---

---

---

---

---

---

---

---

---

---

---

---

---

---

---

---

---

# **ASKO**

Inspired by Scandinavia

The instructions for use can also be found on our website: [www.asko.com](http://www.asko.com)



918059-a1

